

Campbell Hall Replacement

UC Berkeley

MARCH 2008

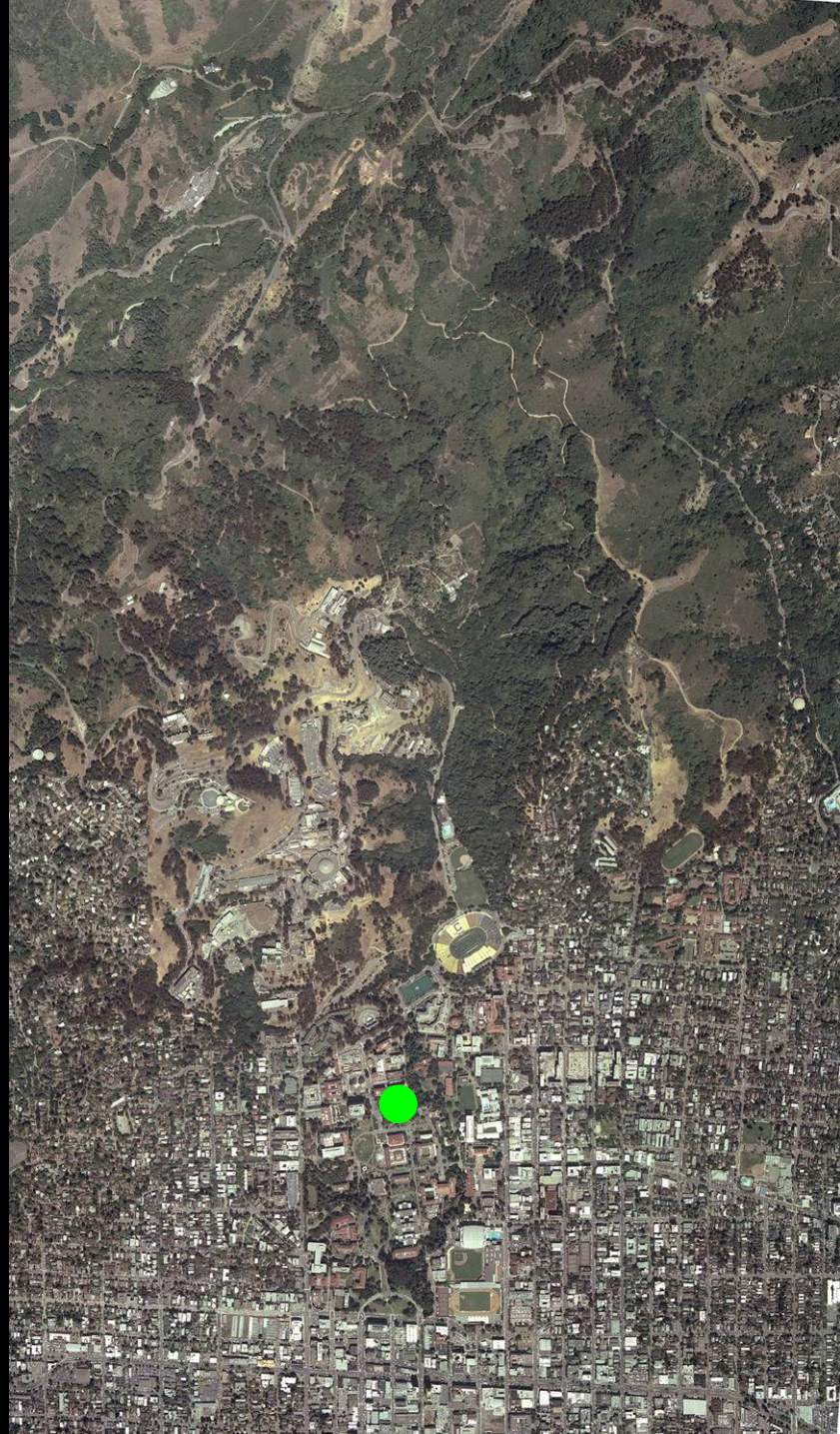

OVERVIEW





- Replaces existing Campbell Hall
 - Completed 1959
 - Poor seismic rating
 - Replacement better value per sq ft than seismic retrofit
- Labs, offices, interaction spaces for Physics and Astronomy
- 25% more sq ft than existing Campbell Hall



Existing Campbell Hall (1959)

PROJECT SITE

- Campus Park classical core defined in 2020 LRDP
- Physical Sciences complex
- UC Berkeley physical sciences strategic initiative:
 - Old LeConte renovation (2007)
 - Birge Hall improvements (2009)

- Campbell Hall 
- Physical Sciences Complex 
- 2020 LRDP Classical Core 
- Downtown Berkeley 





PROJECT SITE

National Register buildings

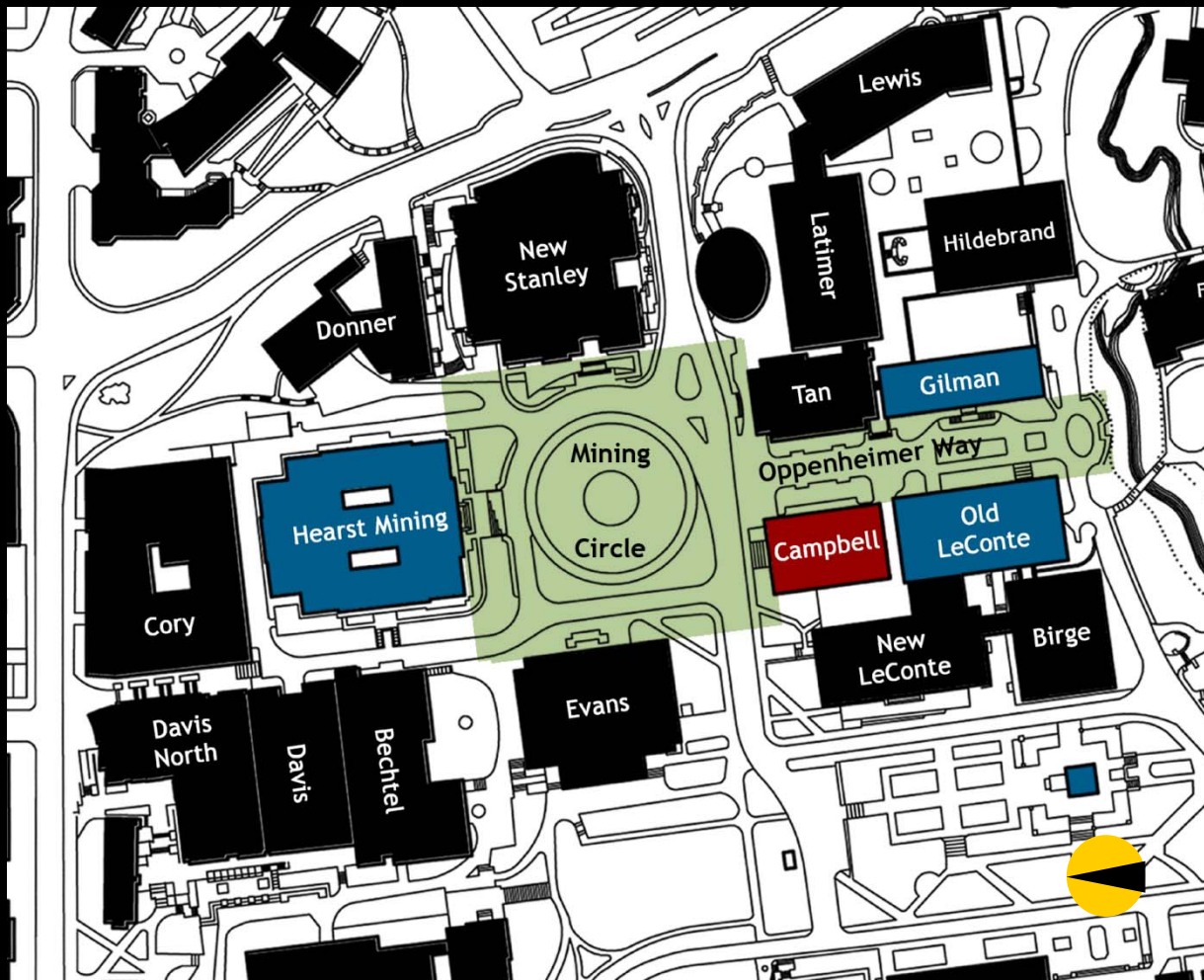
Landscape features: priorities in Landscape Master Plan



-  National Register
-  Priority Landscapes:
 - Mining Circle
 - Oppenheimer Way

PROJECT SITE

Campbell Hall, Tan Hall, New Stanley Hall and Hearst Memorial Mining Building frame the historic Mining Circle

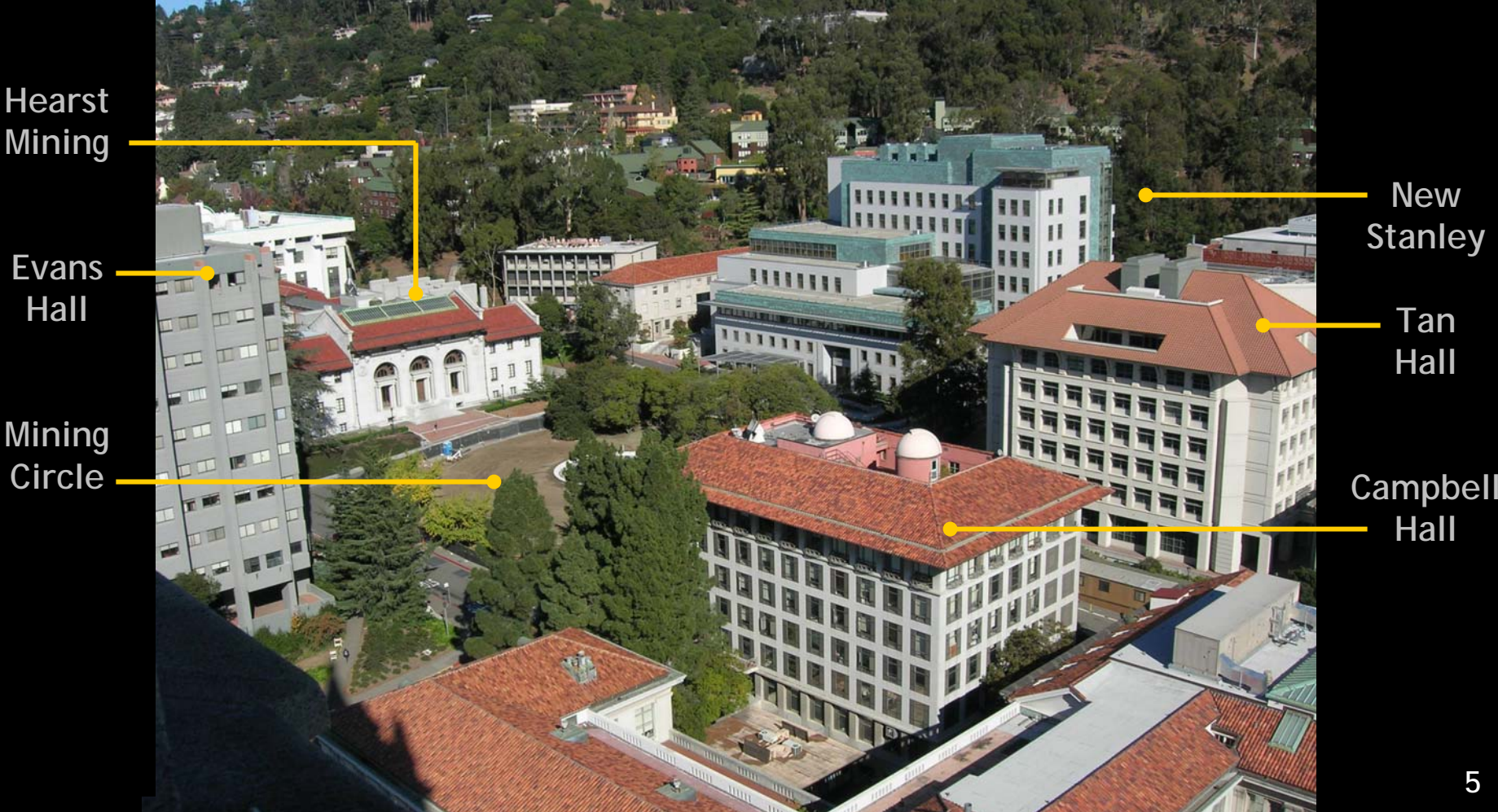



< New Stanley



Gilman >

ENVIRONS



< Hearst Mining



Old LeConte >

ARCHITECTURE

- Campbell Hall faces and frames the Mining Circle and Oppenheimer Way
- Form and design reflect the vocabulary of campus palette



ARCHITECTURE

Punched openings with operable windows provide thermal mass, light control and airflow to offices at north and east



ARCHITECTURE

Northwest: glass and louver wall assembly allows more daylight, controls heat and glare at western exposure



ARCHITECTURE

- **Campus Palette**

Tri-part composition
(base-middle-top)

Pitched tiled roof within
classical core

Precast concrete skin
with sand texture

Primary skin color within
range of legacy buildings

Punched inset windows,
vertical shape

Satin finish metals as trim
and accent materials



Proposed materials



PRECAST CONCRETE (SMOOTH FINISH)

PRECAST CONCRETE (HEAVY SANDBLASTED)



CLAY TILE

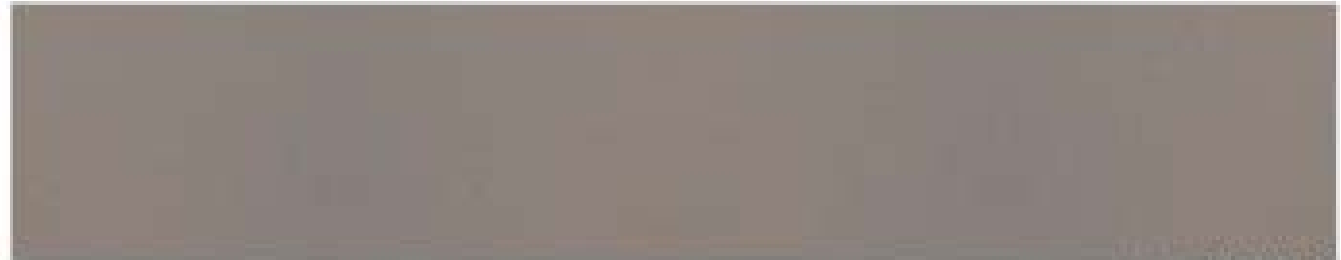

METAL (OPTION 2)



COPPER

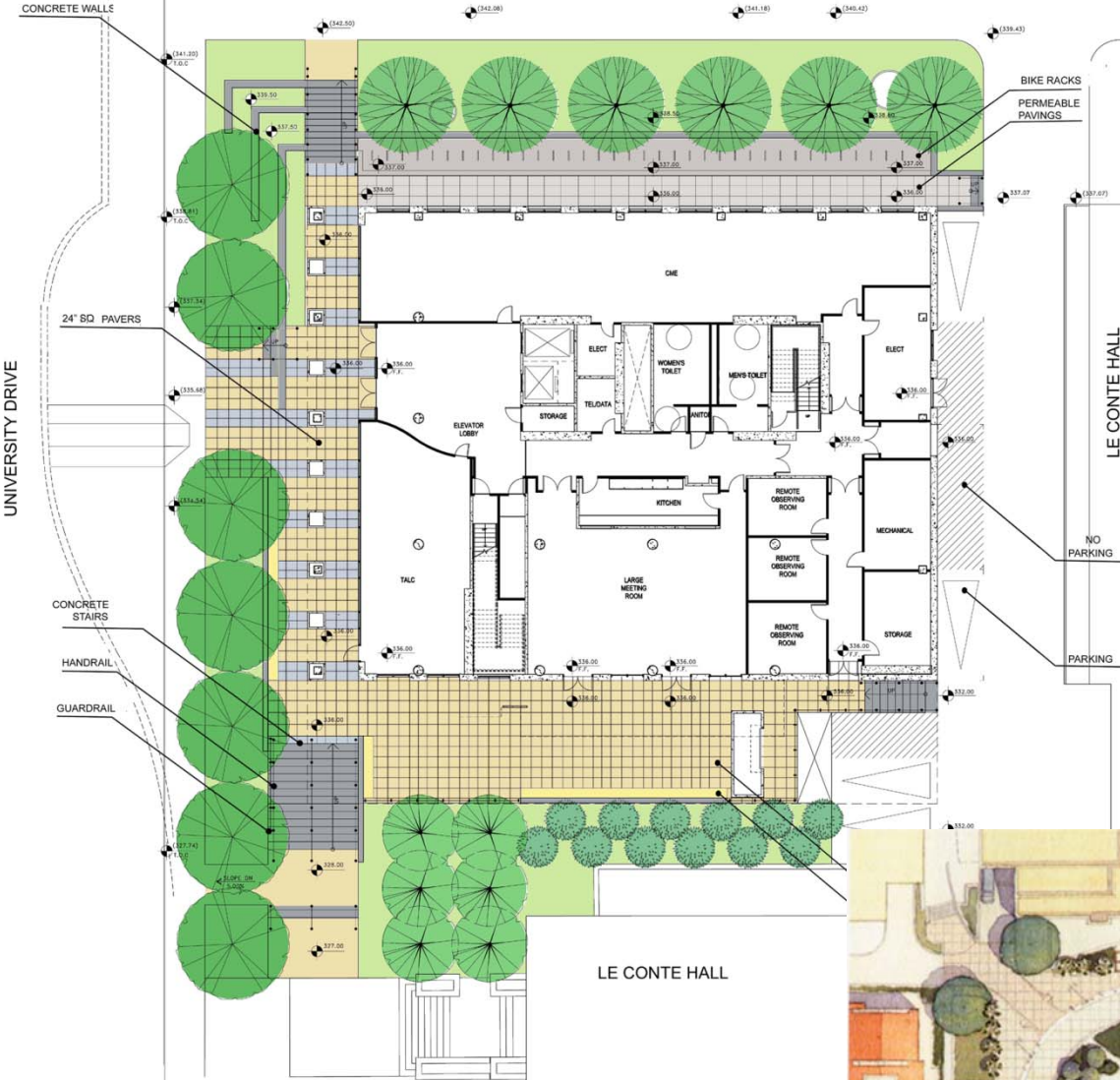

LANDSCAPE

Consistent with
Landscape Heritage
Plan

Landscape Heritage Plan (2004)

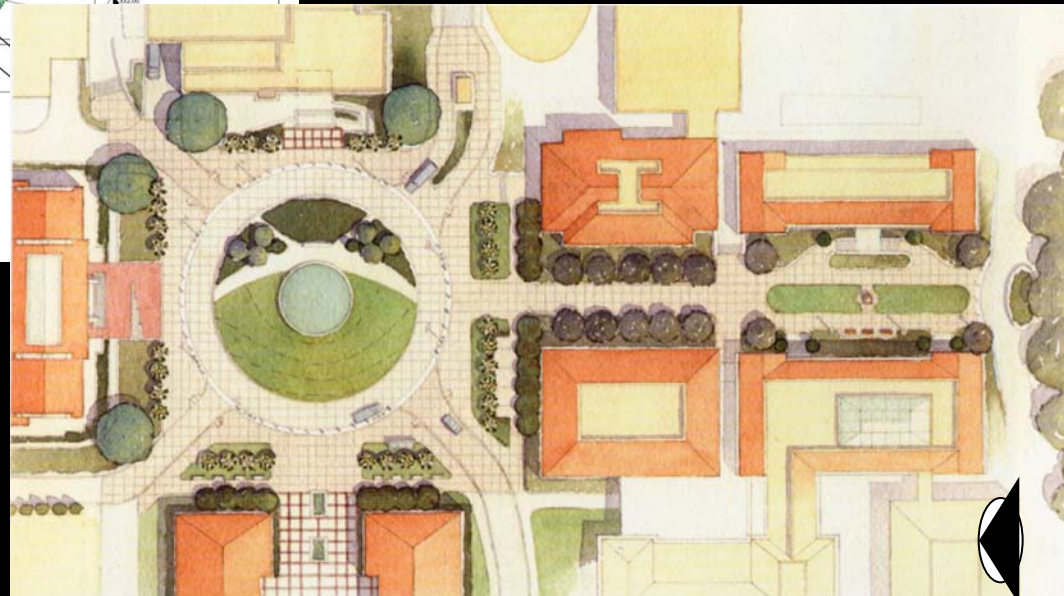

PROGRAM BASEMENT



- Office: Private
- Office: Open
- Astronomy Lab
- Physics Lab
- Interaction
- Building Core
- Mechanical
- Support

PROGRAM GROUND FLOOR

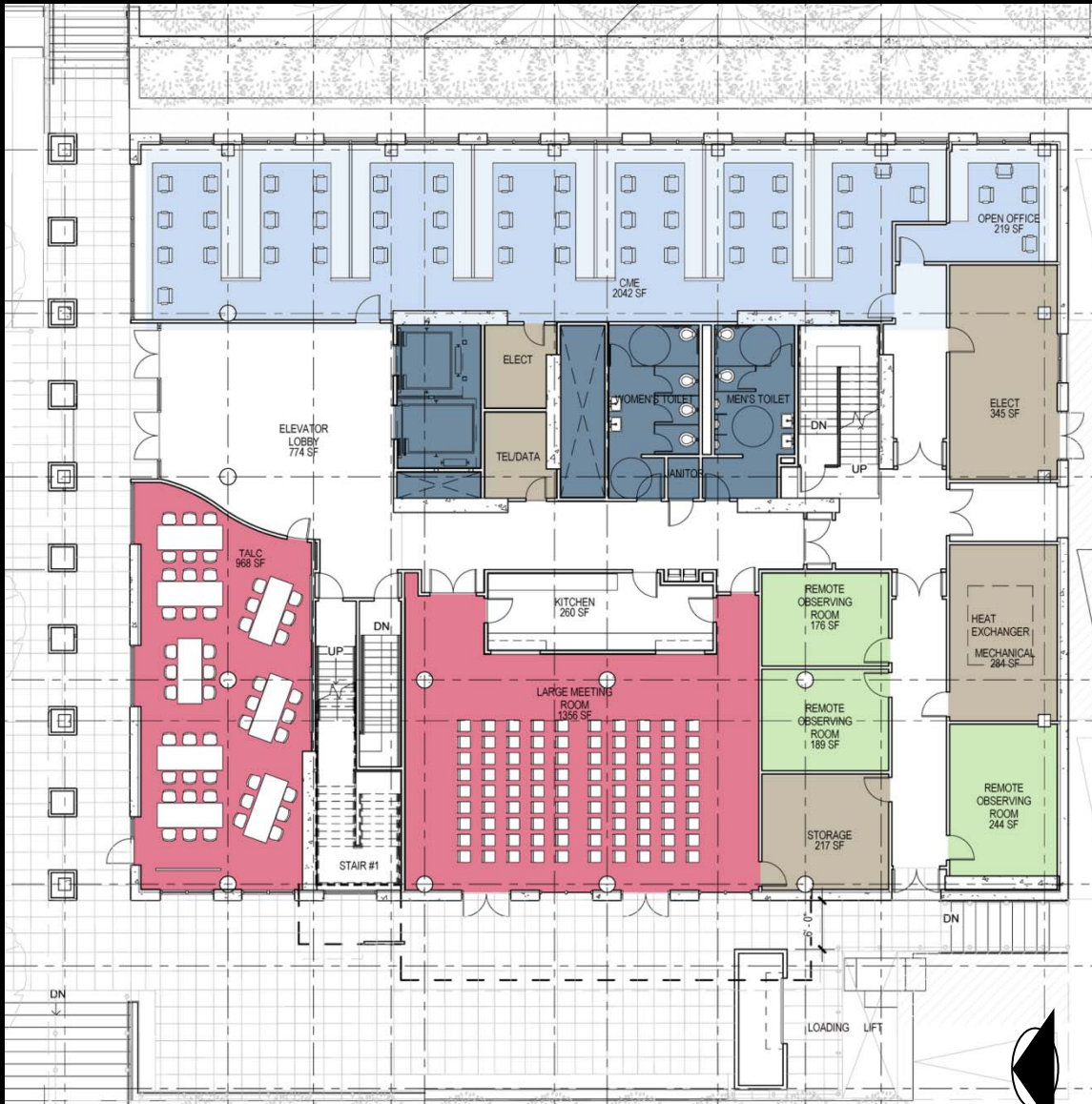

- Office: Private
- Office: Open
- Astronomy Lab
- Physics Lab
- Interaction
- Building Core
- Mechanical
- Support

CAMPBELL HALL REPLACEMENT

PROGRAM TOP FLOOR



- Office: Private
- Office: Open
- Astronomy Lab
- Physics Lab
- Interaction
- Building Core
- Mechanical
- Support

GREEN DESIGN

- Target: equivalent to LEED silver rating
- Target: outperform Title 24 by >20%
- Operable windows
- Floors zoned by function: future flexibility, optimum environmental control
- More intense use of already developed site

CAMPBELL HALL REPLACEMENT



