

BUILDING A MASTER-PLANNED CAMPUS COMMUNITY



Goals and Objectives

- ❖ Timeless architecture that conveys an experience of permanence and quality
- ❖ Projects that create an “identifiable place”
- ❖ Density management (through buildout)
- ❖ Reconcile scale vs. density dilemma
- ❖ Exemplary energy efficiency
- ❖ No major maintenance for twenty years
- ❖ On-time, on-budget
- ❖ Circulation and parking that reinforce campus design goals
- ❖ Most attractive research campus in U.S.

UCIrvine



UCIrvine



UCIrvine



UCIrvine

- ❖ **Campus and community jointly master-planned**
- ❖ **University of 28,000 students**
- ❖ **City of 100,000 residents**

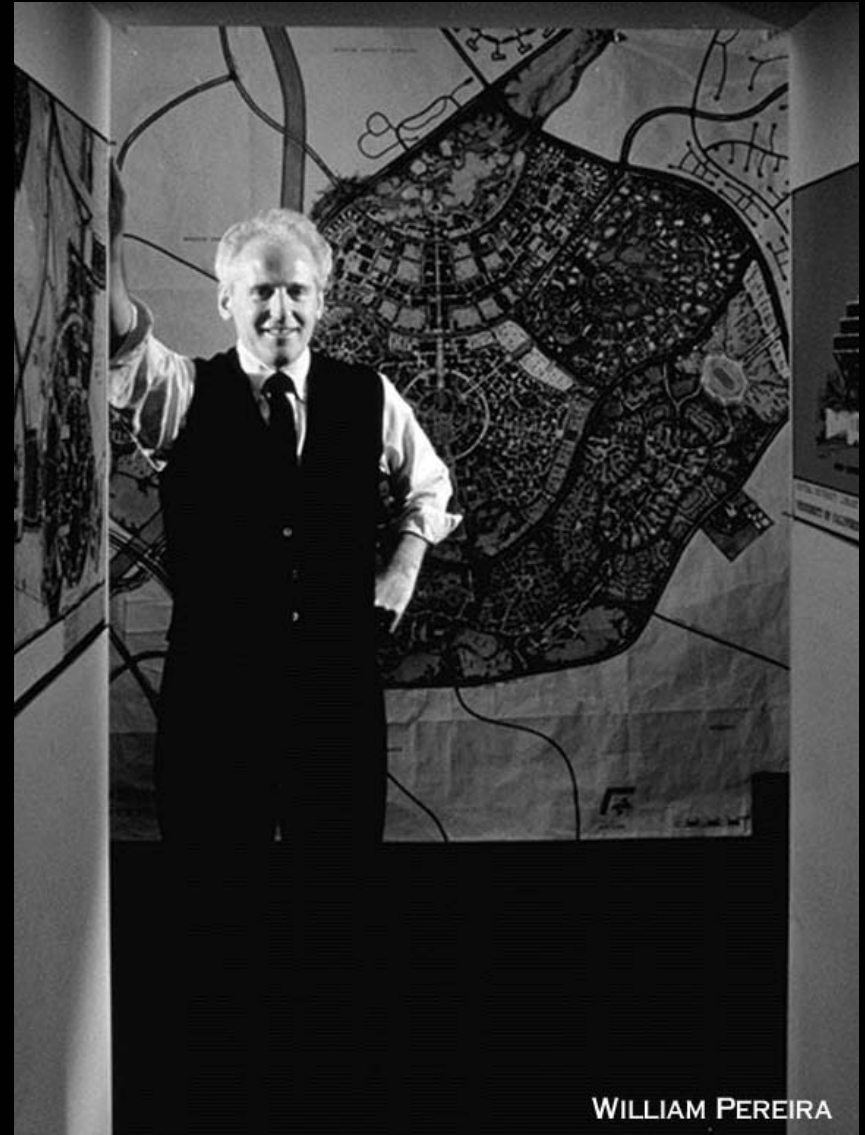

WILLIAM PEREIRA

UCIrvine



Planning Vision for UCI:

- ❖ University directly linked with a city
- ❖ Comprehensive academic community
- ❖ Strong planning framework

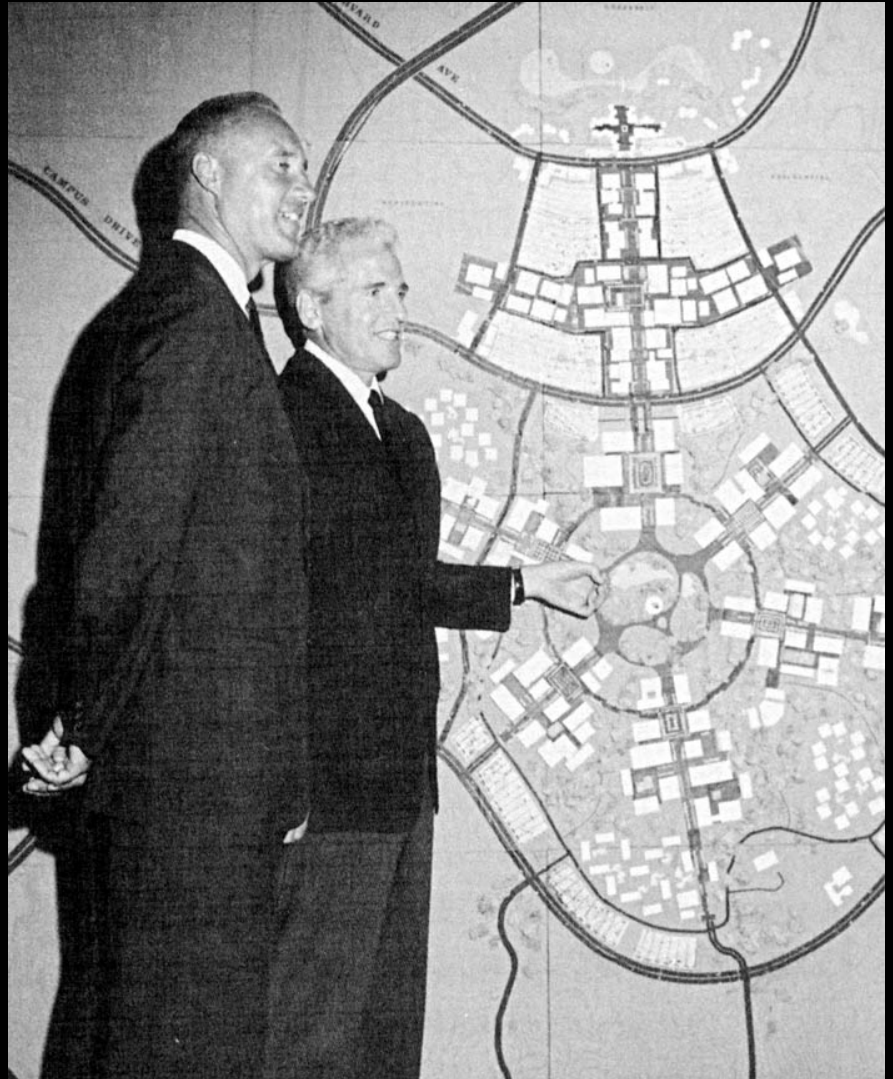

CHANCELLOR ALDRICH AND MR. PEREIRA

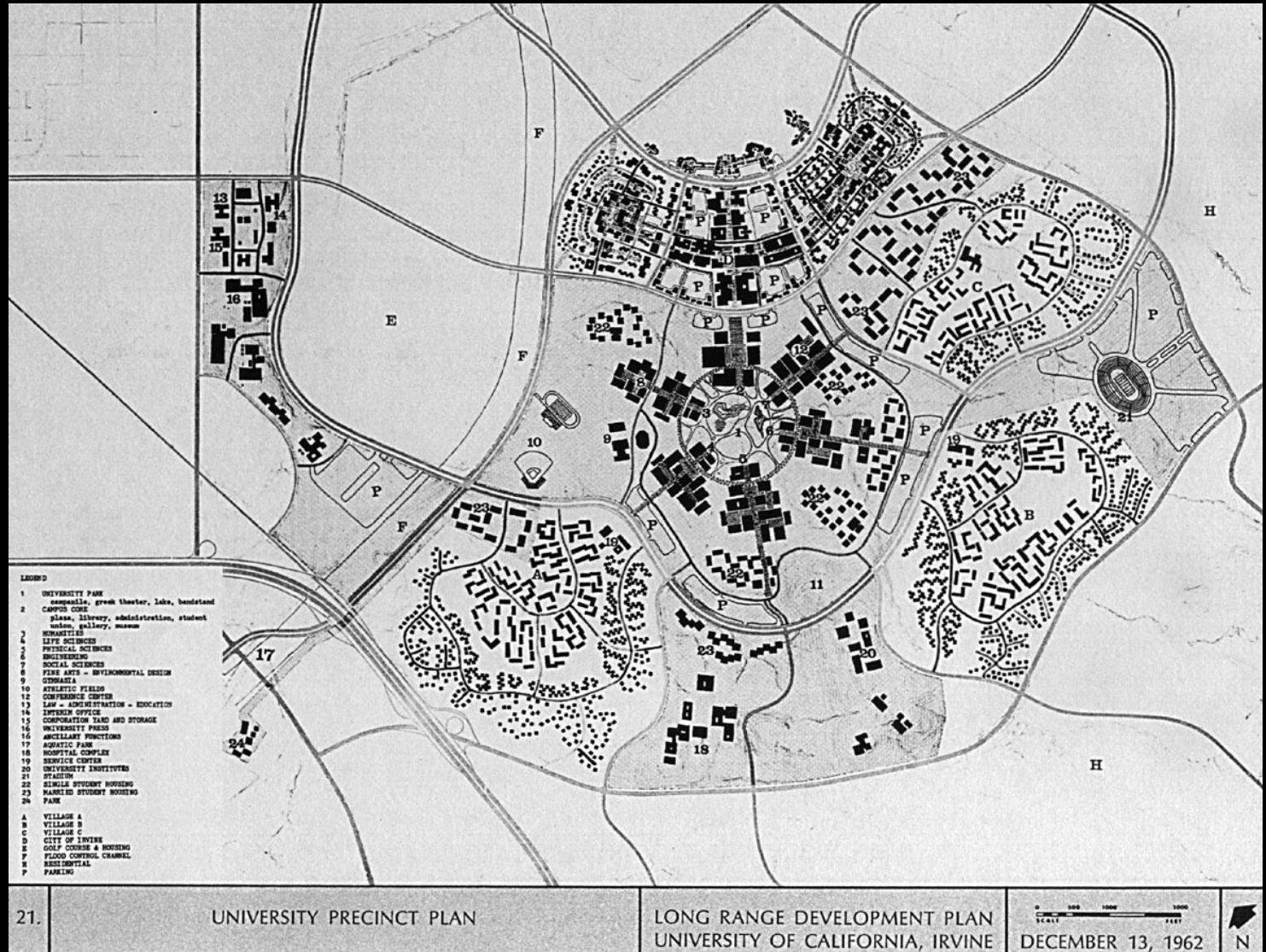

UCIrvine

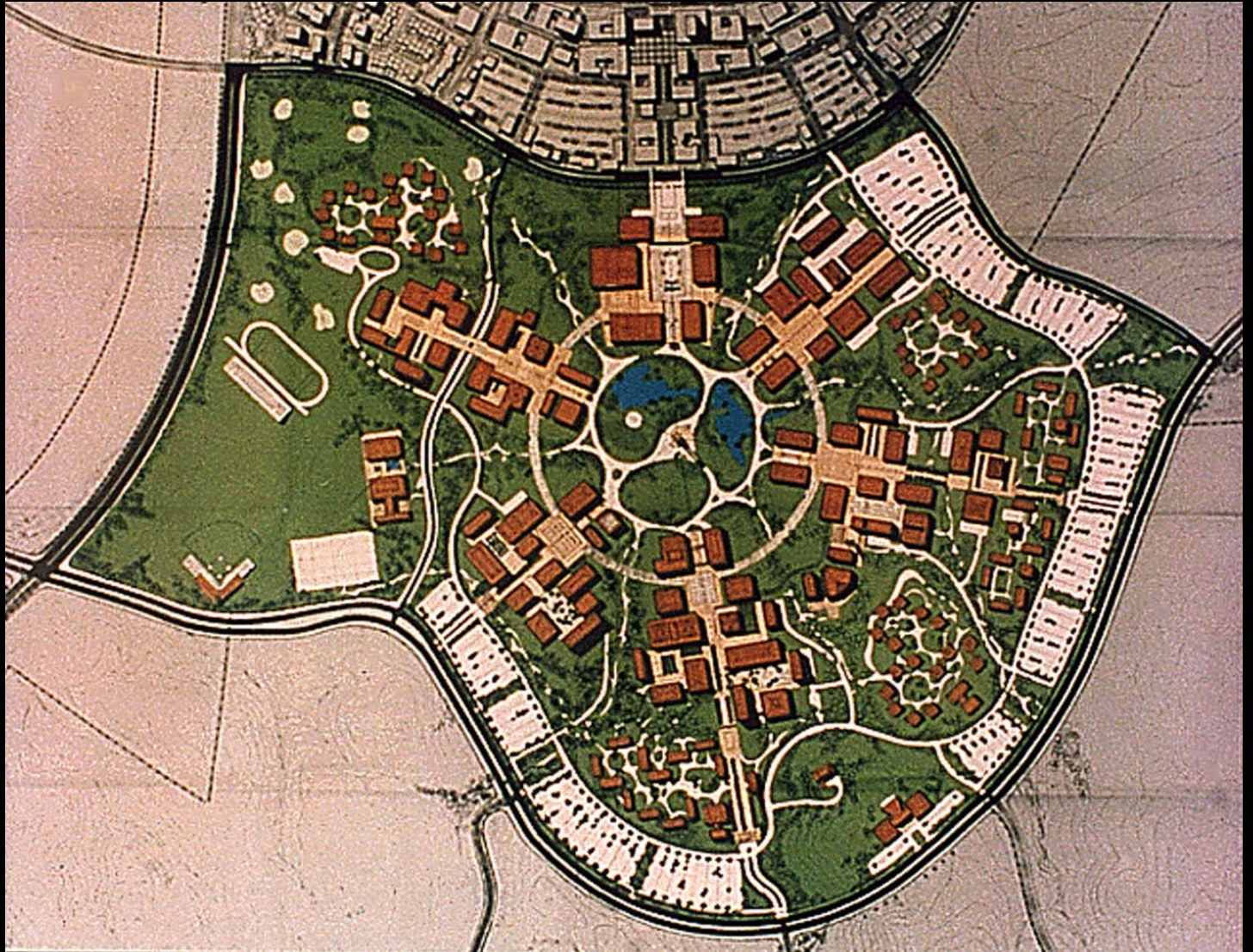

CENTRAL CORE, 1963 LRDP

UCIrvine



CENTRAL CORE, 1967

UCIrvine



CENTRAL CORE, 1972

UCIrvine



CENTRAL CORE TODAY

UCIrvine

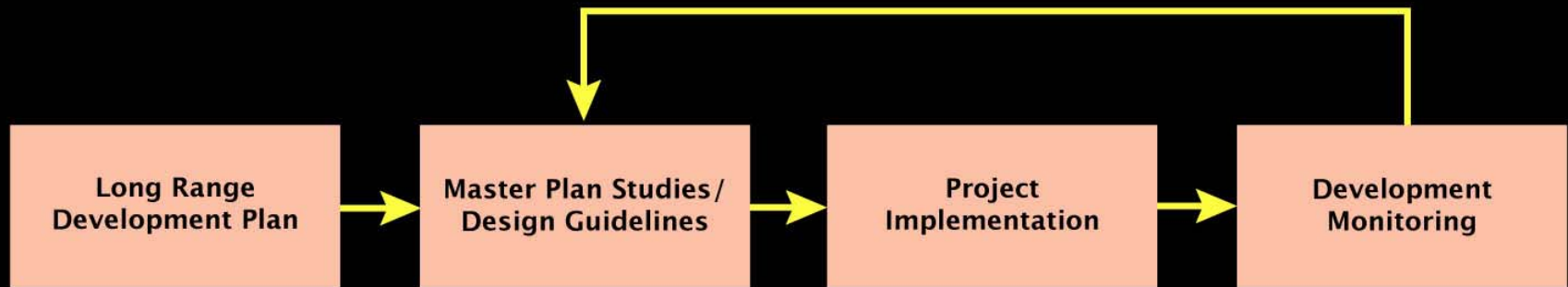

UCIrvine

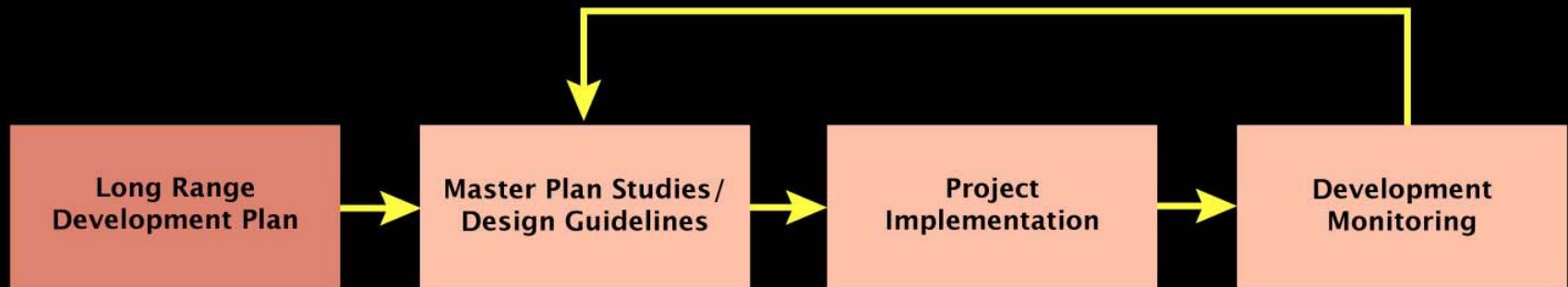

LRDP LAND USE PLAN

University of California, Irvine

LEGEND

- | | |
|----------------------------|----------------------------|
| AS Academic & Support | SH Housing-Student |
| CS Campus Support Services | FS Housing-Faculty/Staff |
| RD Research & Development | OS Open Space & Recreation |
| MU Mixed Use | P Parking |
| SC Support Commercial | |

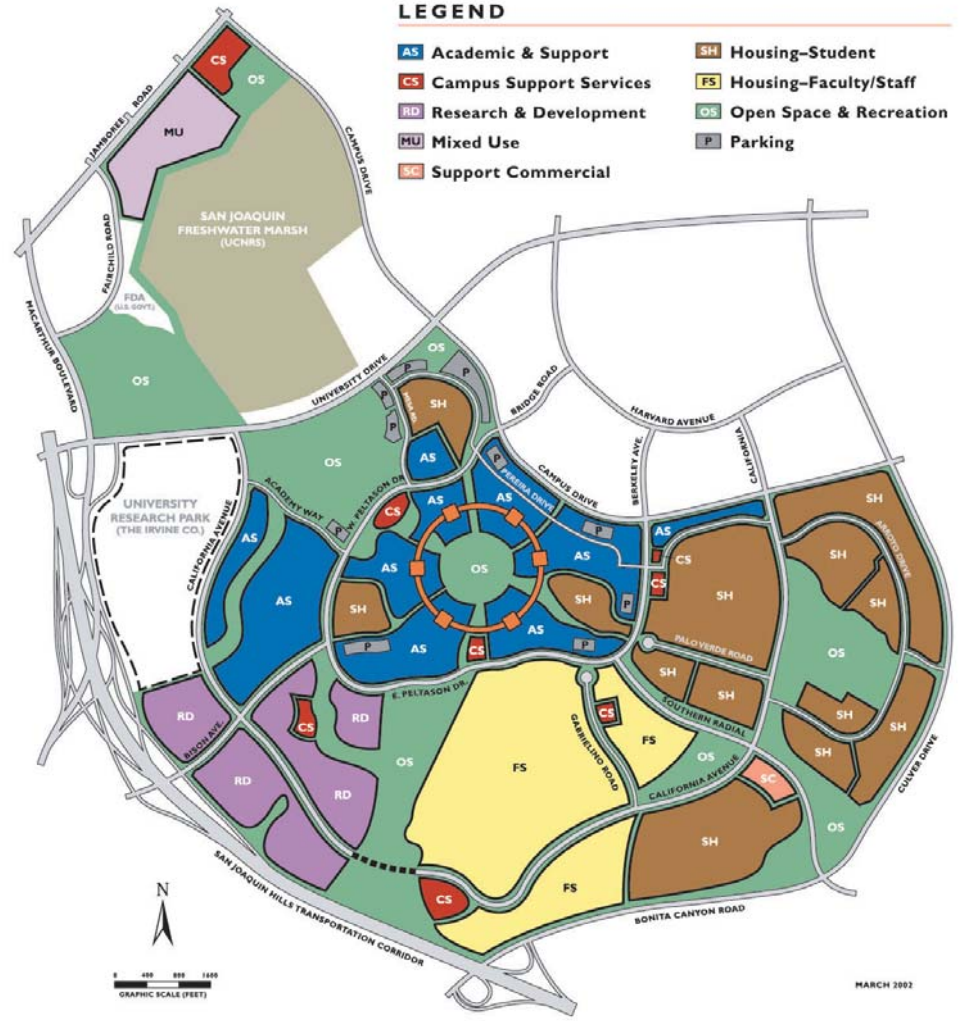

UCIrvine



LANDSCAPE FRAMEWORK

UCIrvine

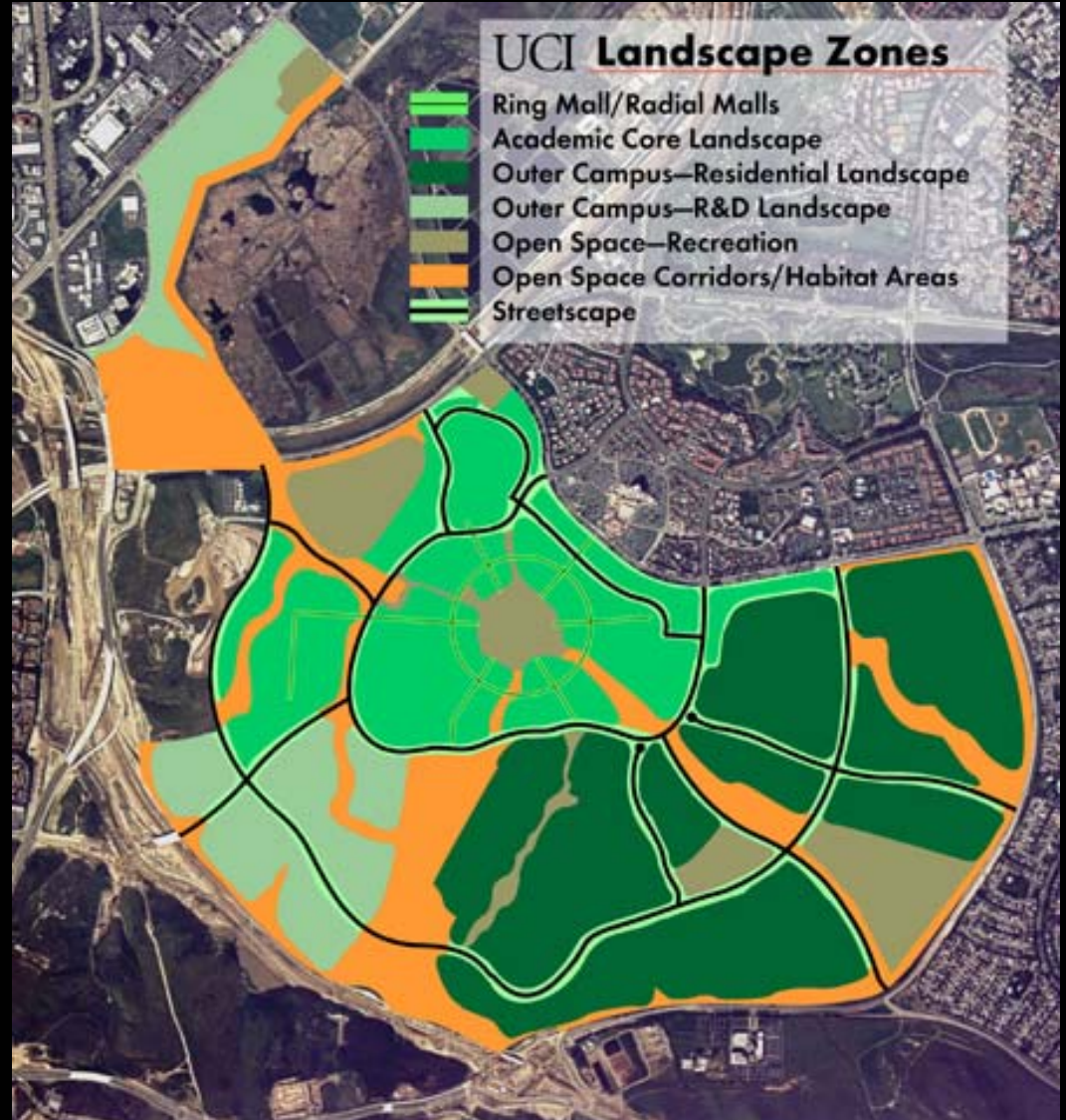

UCIrvine

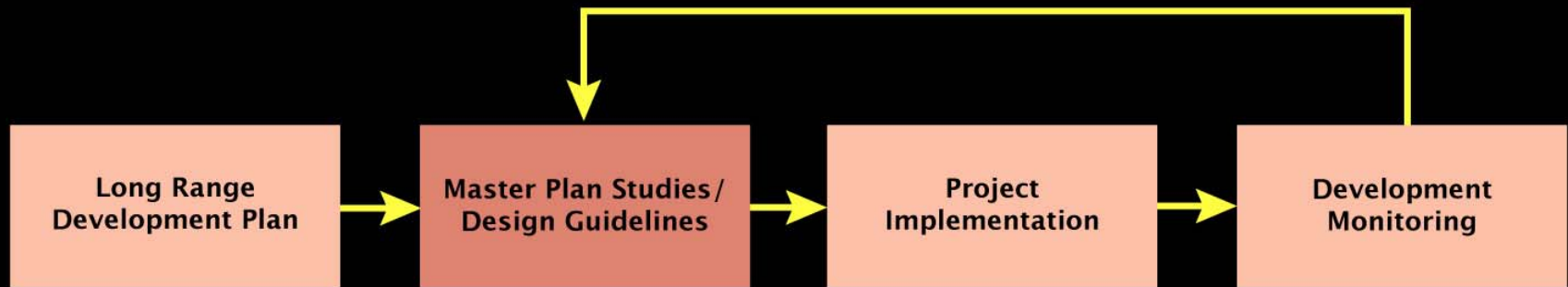

UCIrvine



CAMPUS SECTORS

UCIrvine

Central Core:

- ❖ 343 acres
- ❖ Existing academic and support: 3.2 million GSF
- ❖ Targeted academic and support: 6.6 million GSF
- ❖ Capacity: 8.6 million GSF

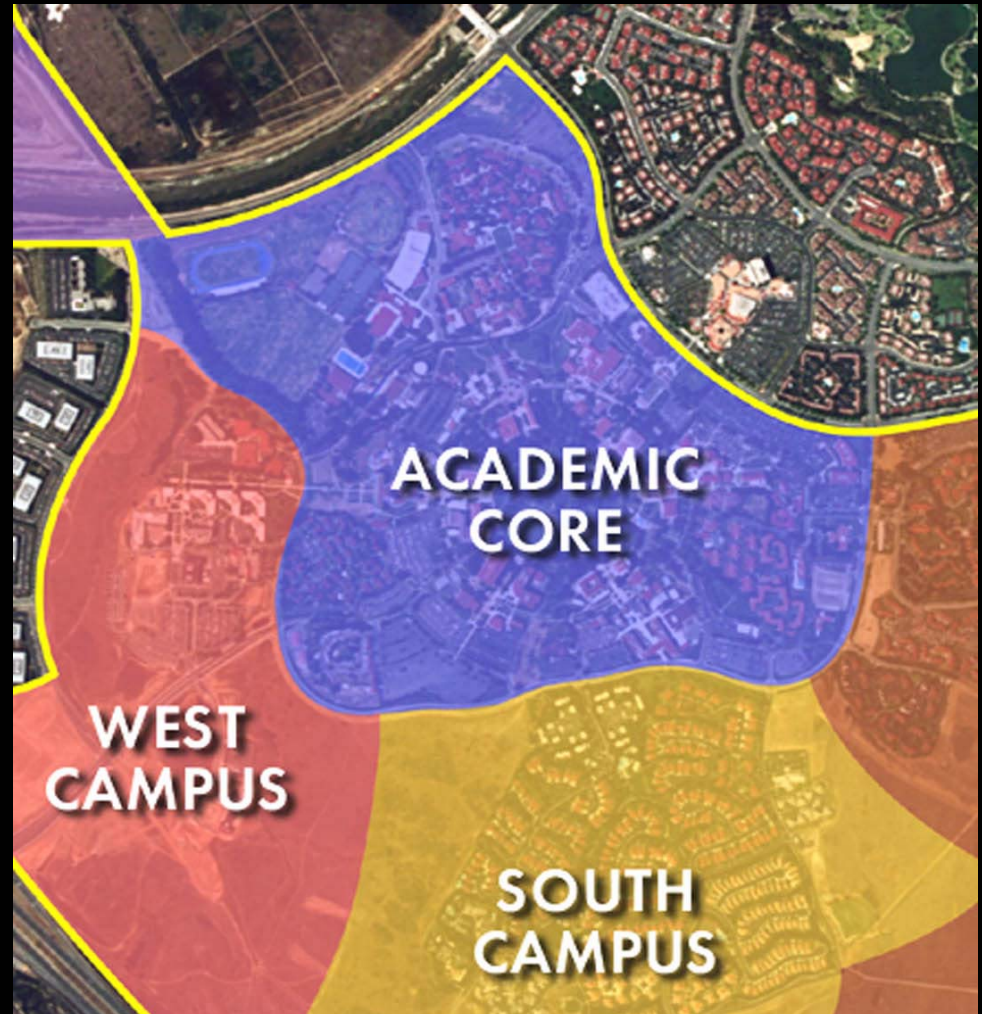

UCIrvine

Key Issues:

- ❖ Managing density
- ❖ Human scale
- ❖ Cohesive campus environment

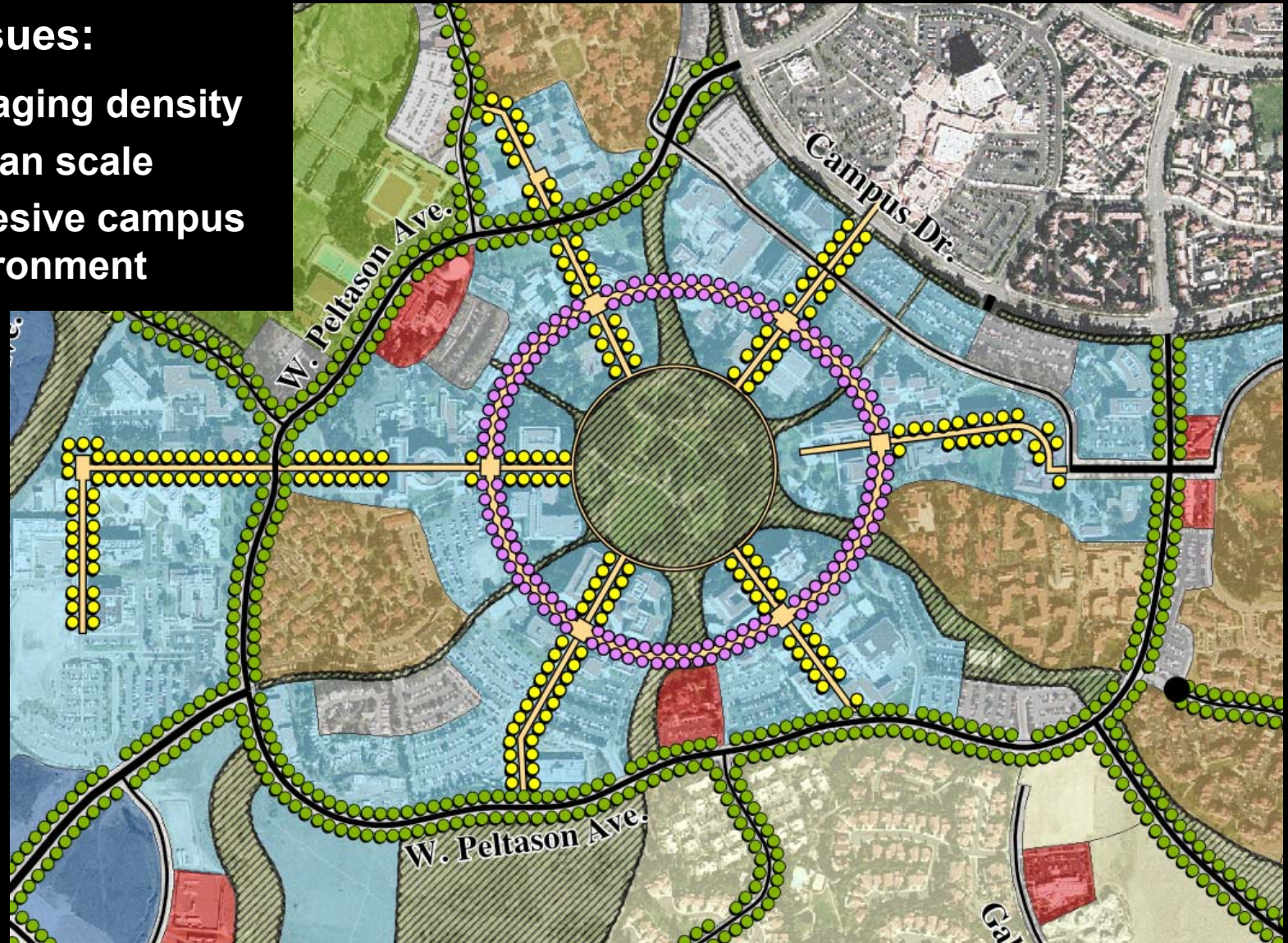

UCIrvine



CENTRAL CORE, EXISTING DEVELOPMENT

UCIrvine

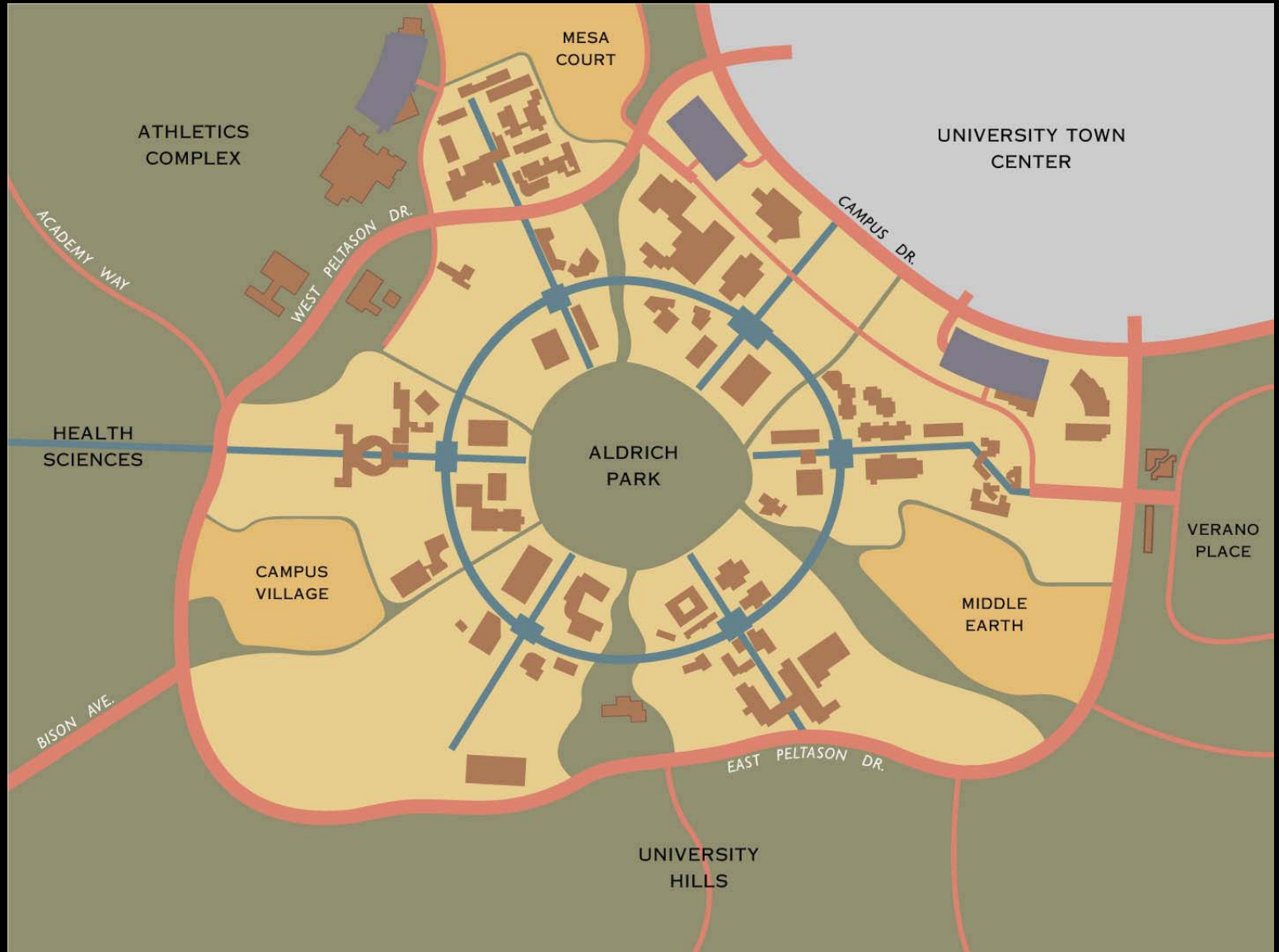

CENTRAL CORE, EXISTING DEVELOPMENT

UCIrvine



CENTRAL CORE, ULTIMATE DEVELOPMENT

UCIrvine



CENTRAL CORE, ULTIMATE DEVELOPMENT

UCIrvine

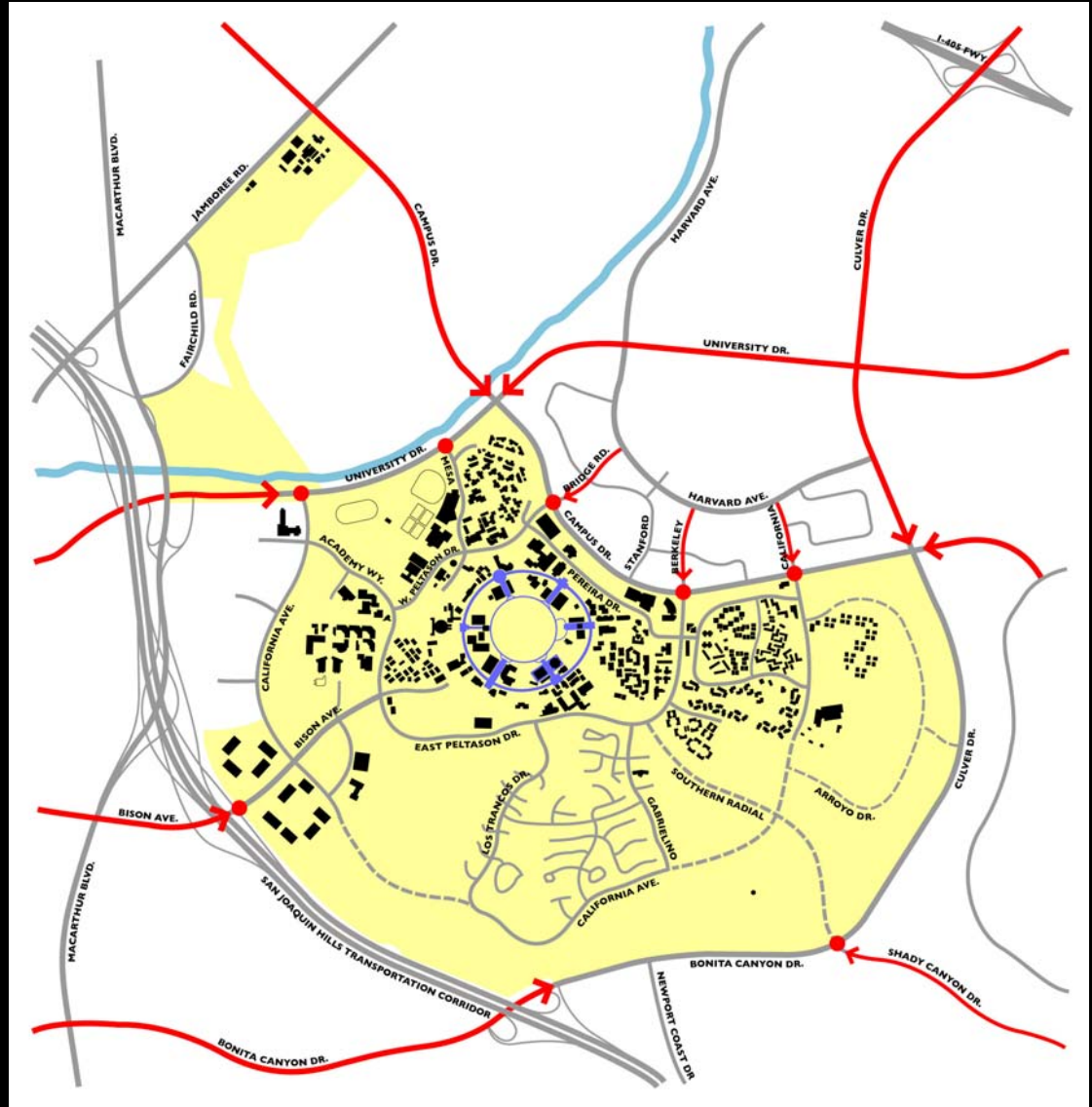

CAMPUS ENTRIES

UCIrvine

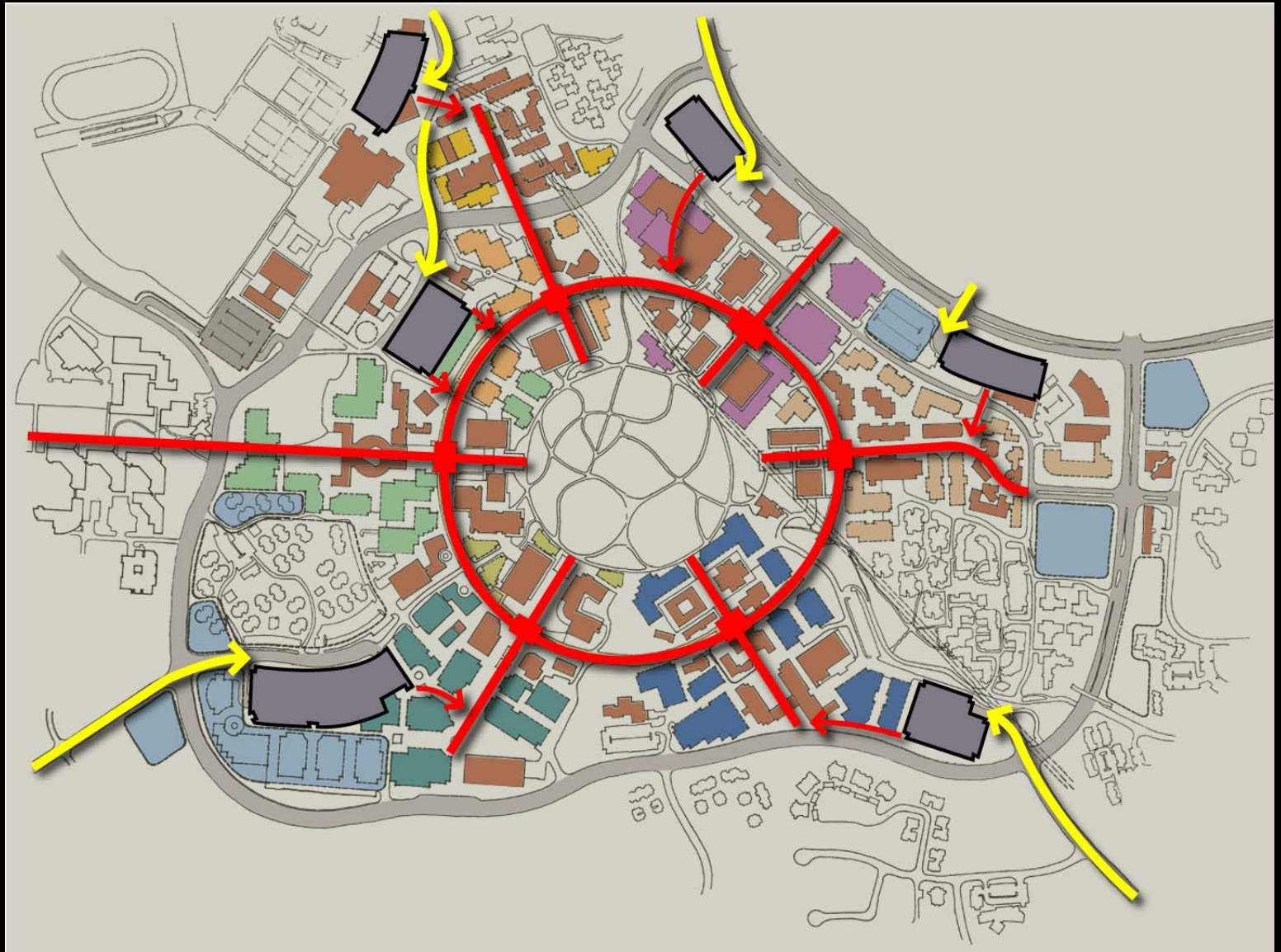

CENTRAL CORE, CIRCULATION & PARKING

UCIrvine

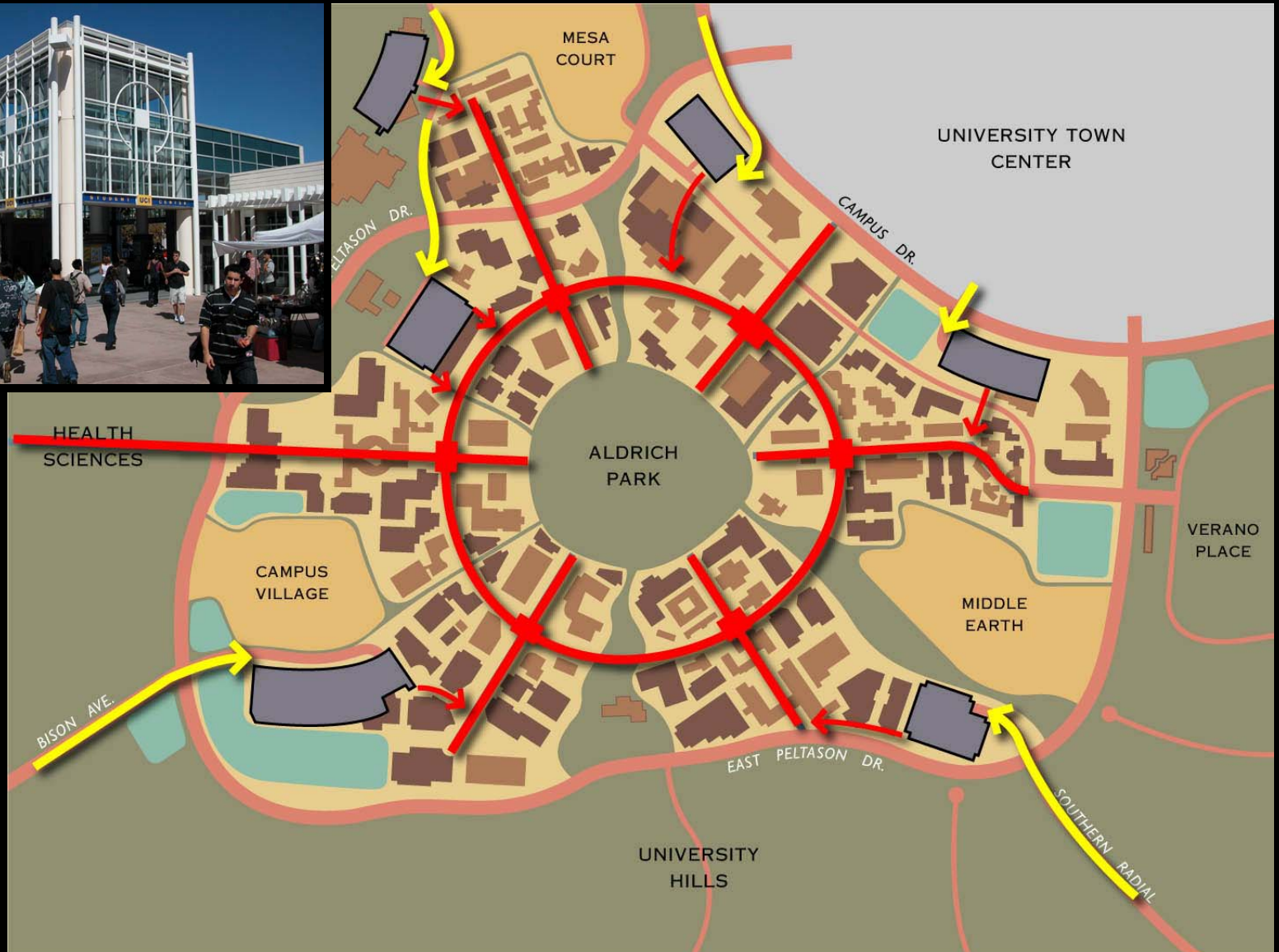

CENTRAL CORE, CIRCULATION & PARKING

UCIrvine

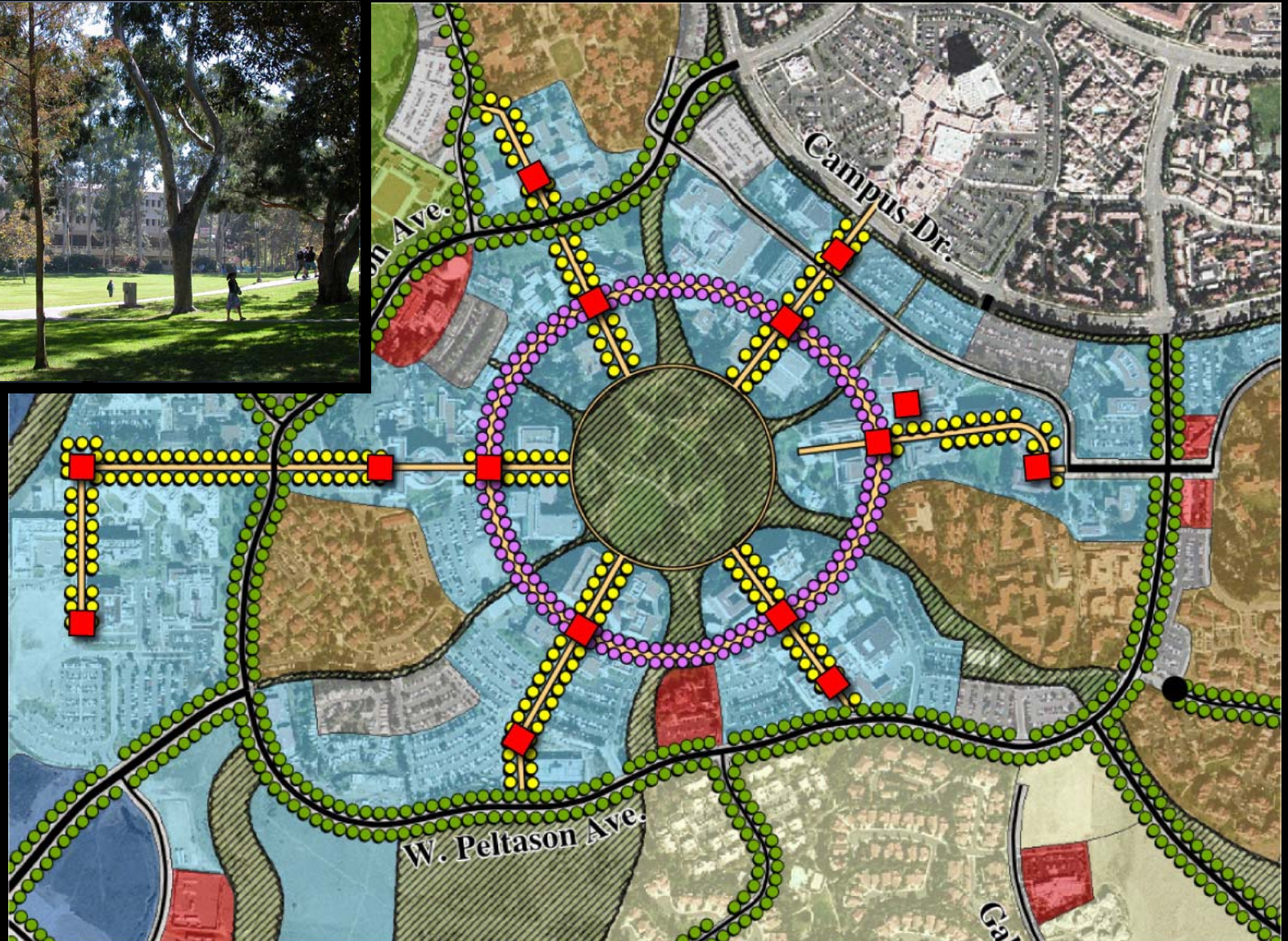

CENTRAL CORE, LANDSCAPE & URBAN DESIGN

UCIrvine

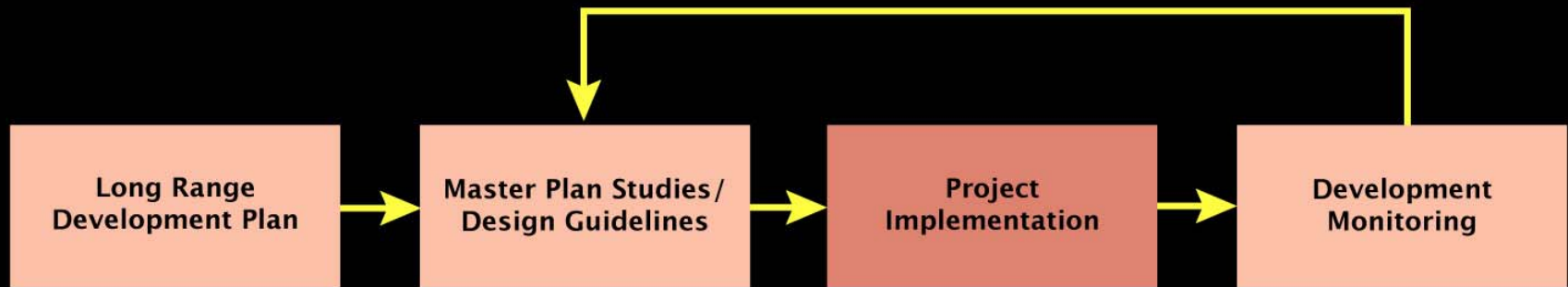

UCIrvine



CENTRAL CORE TODAY

UCIrvine

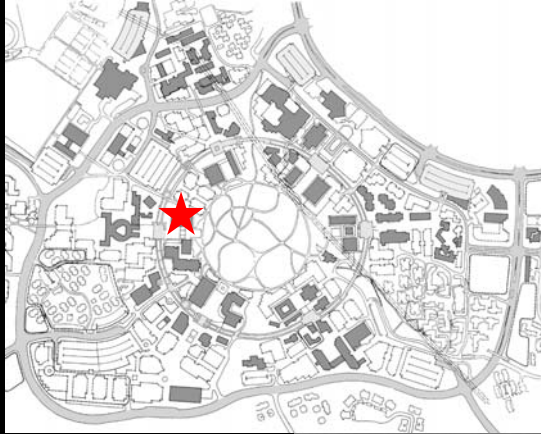

Architectural Context



STEINHAUS HALL

UCIrvine

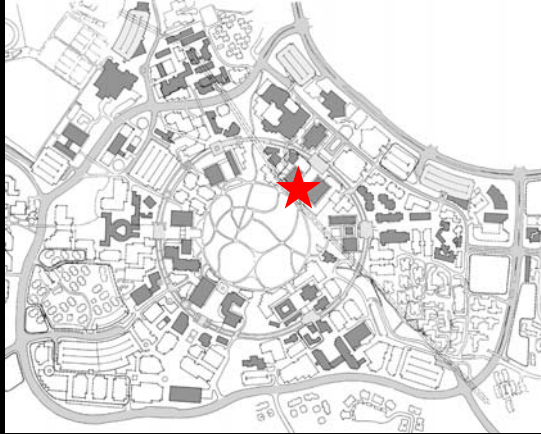

GATEWAY COMMONS, MAIN LIBRARY

UCIrvine

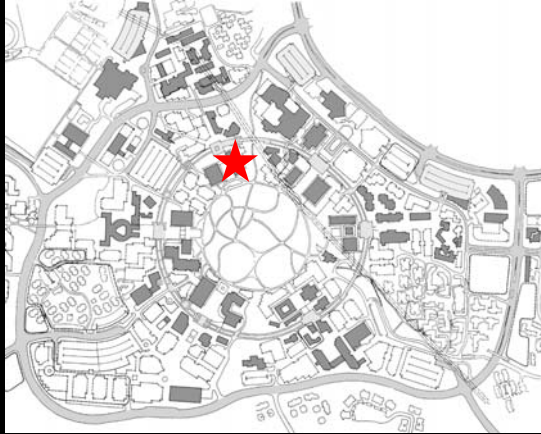

HUMANITIES OFFICE BUILDING

UCIrvine



HUMANITIES OFFICE BUILDING

UCIrvine



HUMANITIES OFFICE BUILDING

UCIrvine

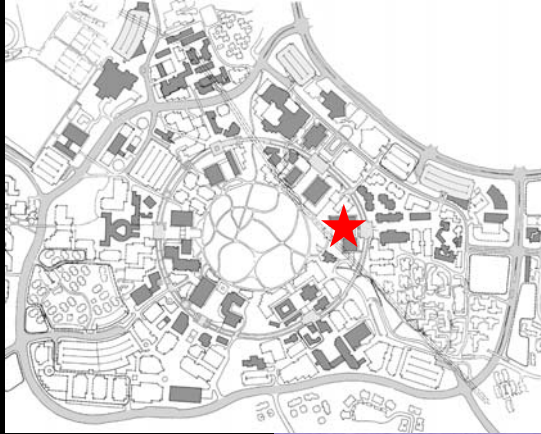

SOCIAL SCIENCES

UCIrvine

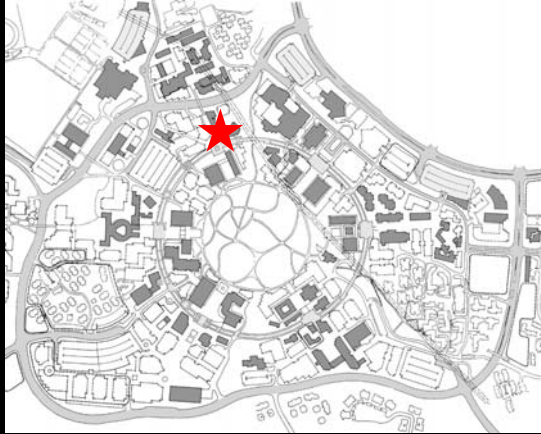

HUMANITIES INSTRUCTIONAL BUILDING

UCIrvine



HUMANITIES INSTRUCTIONAL BUILDING

UCIrvine



HUMANITIES INSTRUCTIONAL BUILDING

UCIrvine

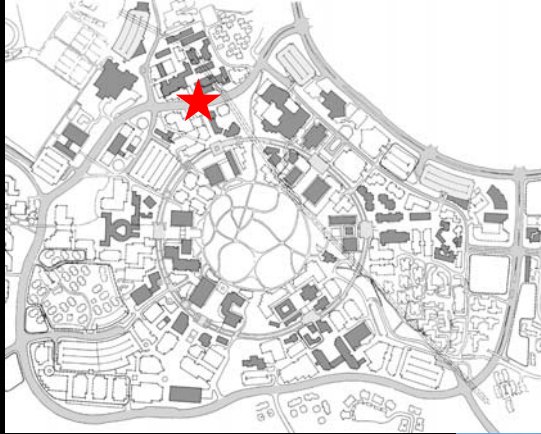

HUMANITIES/ARTS PEDESTRIAN BRIDGE

UCIrvine

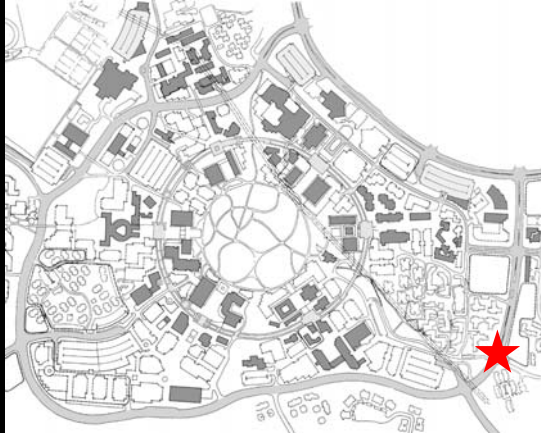

MIDDLE EARTH/PALOS VERDE PEDESTRIAN BRIDGE

UCIrvine

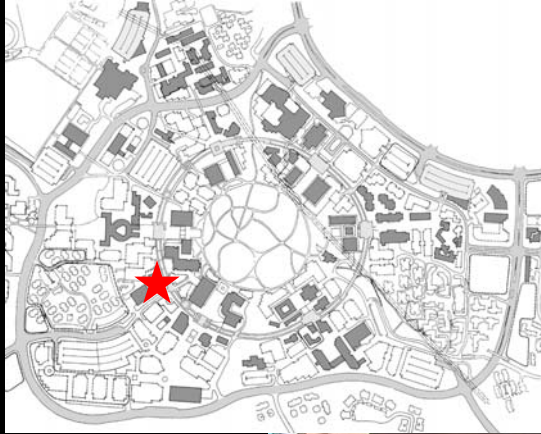

NATURAL SCIENCES UNIT 1



UCIrvine

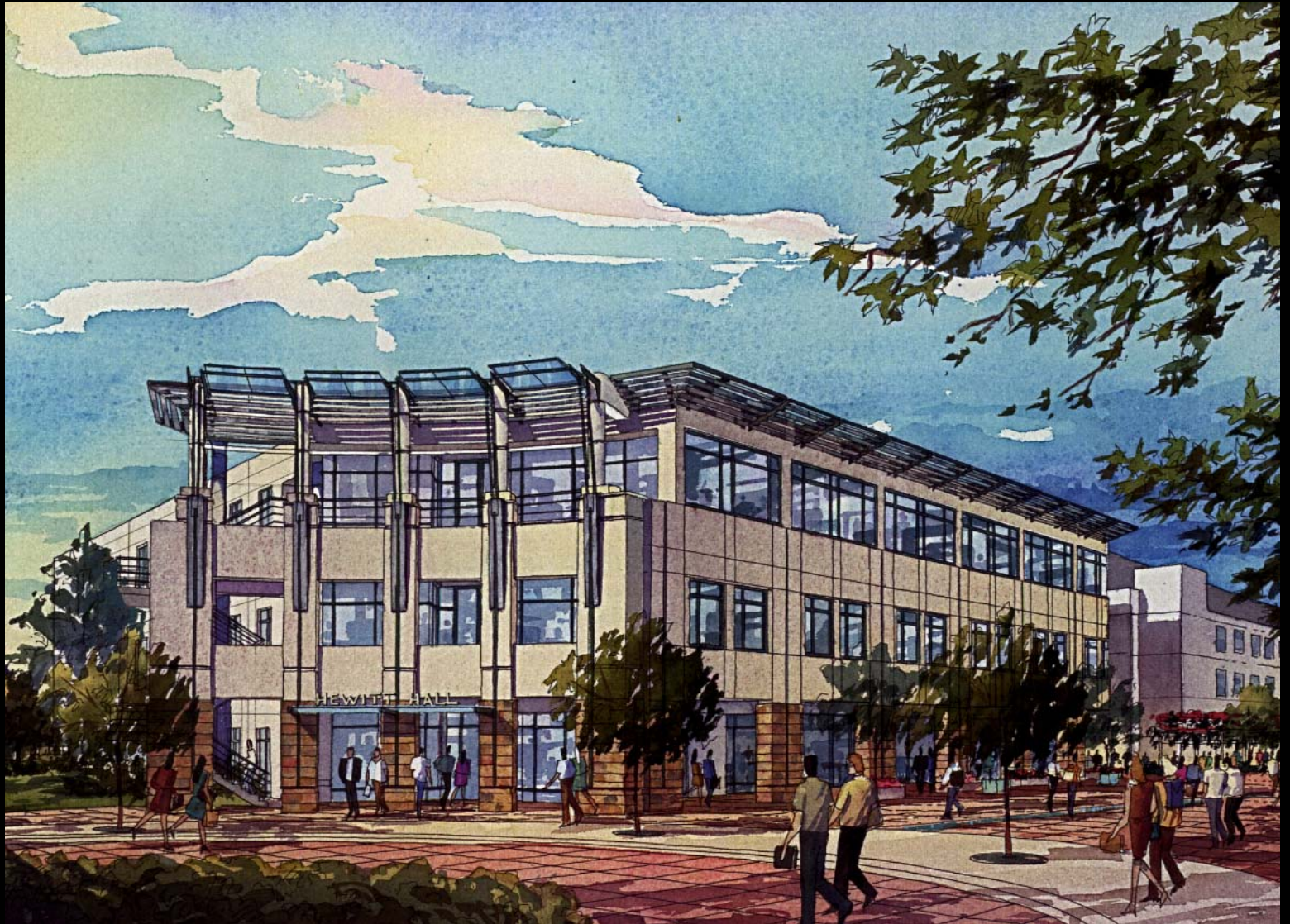

HEWITT HALL

UCIrvine

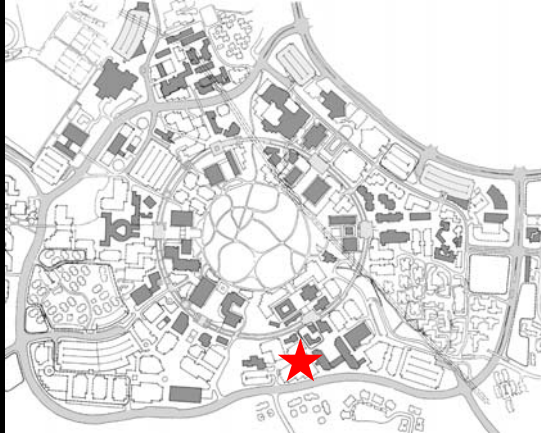

UCIrvine

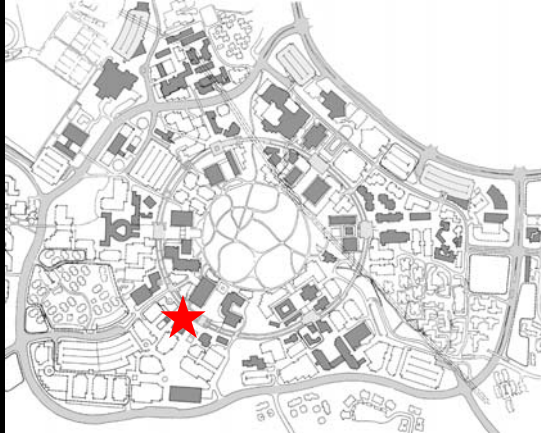

CROUL HALL

UCIrvine

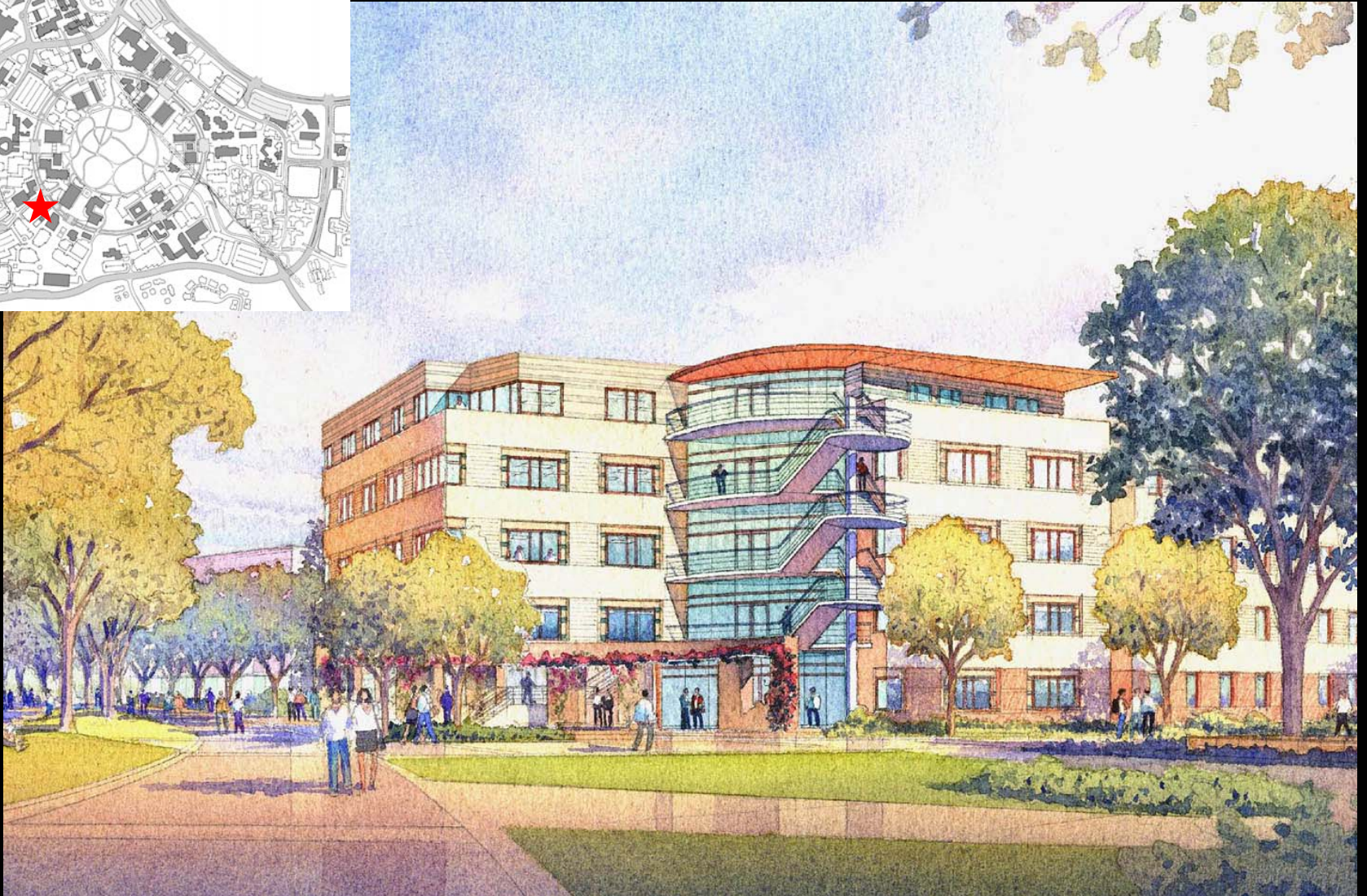
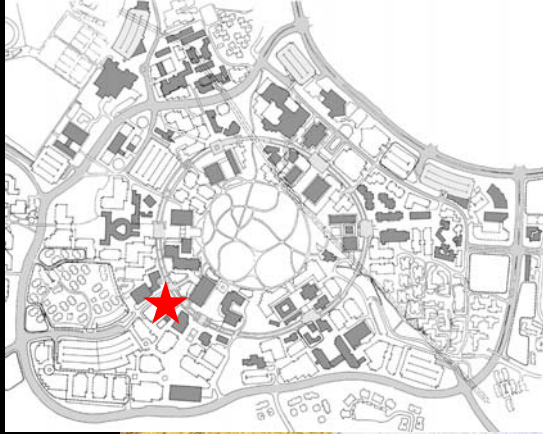

NATURAL SCIENCES UNIT 2

UCIrvine

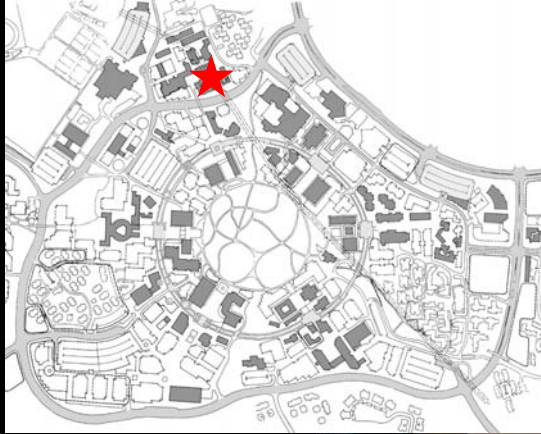

MUSIC & MEDIA BUILDING

UCIrvine

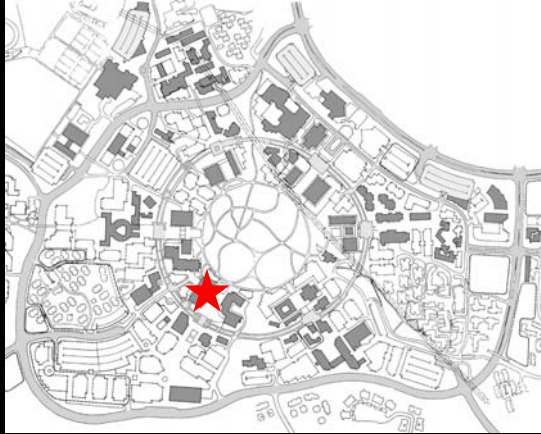

Place-Making



ROWLAND HALL

UCIrvine

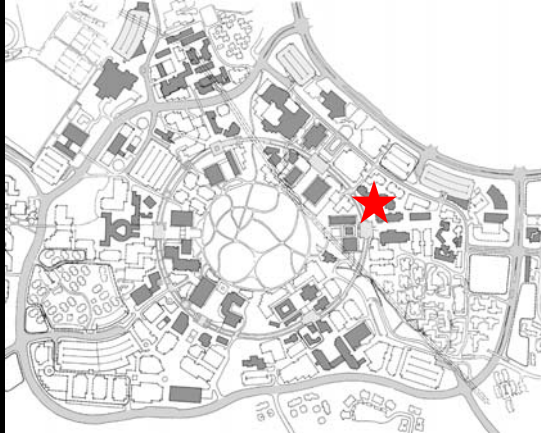

SOCIAL SCIENCE PLAZA

UCIrvine

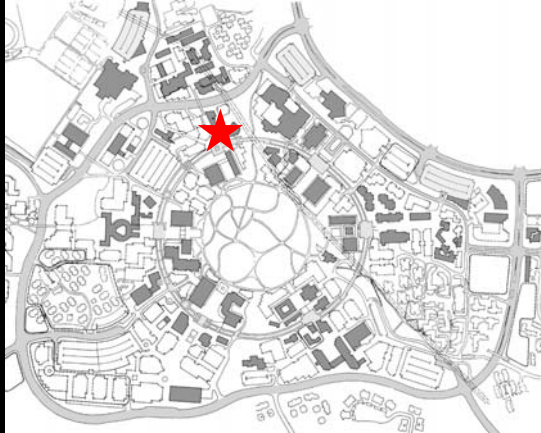

HUMANITIES INSTRUCTIONAL BUILDING

UCIrvine

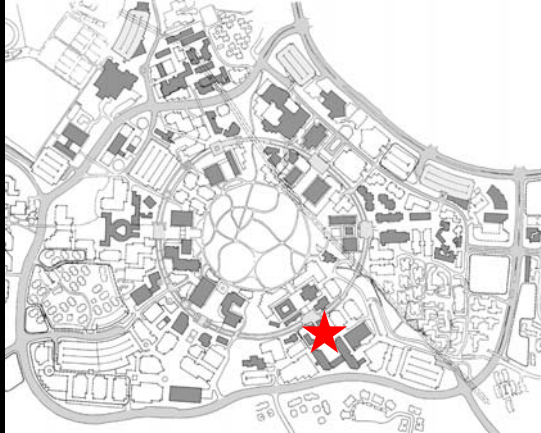

UCIrvine



ANTEATER RECREATION CENTER



SOCIAL SCIENCES QUAD



BIOLOGICAL SCIENCES QUAD



Materials

HUMANITIES QUAD

UCIrvine



ENGINEERING/ICS QUAD



PHYSICAL SCIENCES QUAD

UCIrvine



UCI REVIEW & APPROVAL PROCESS FOR DESIGN & PLANNING ISSUES

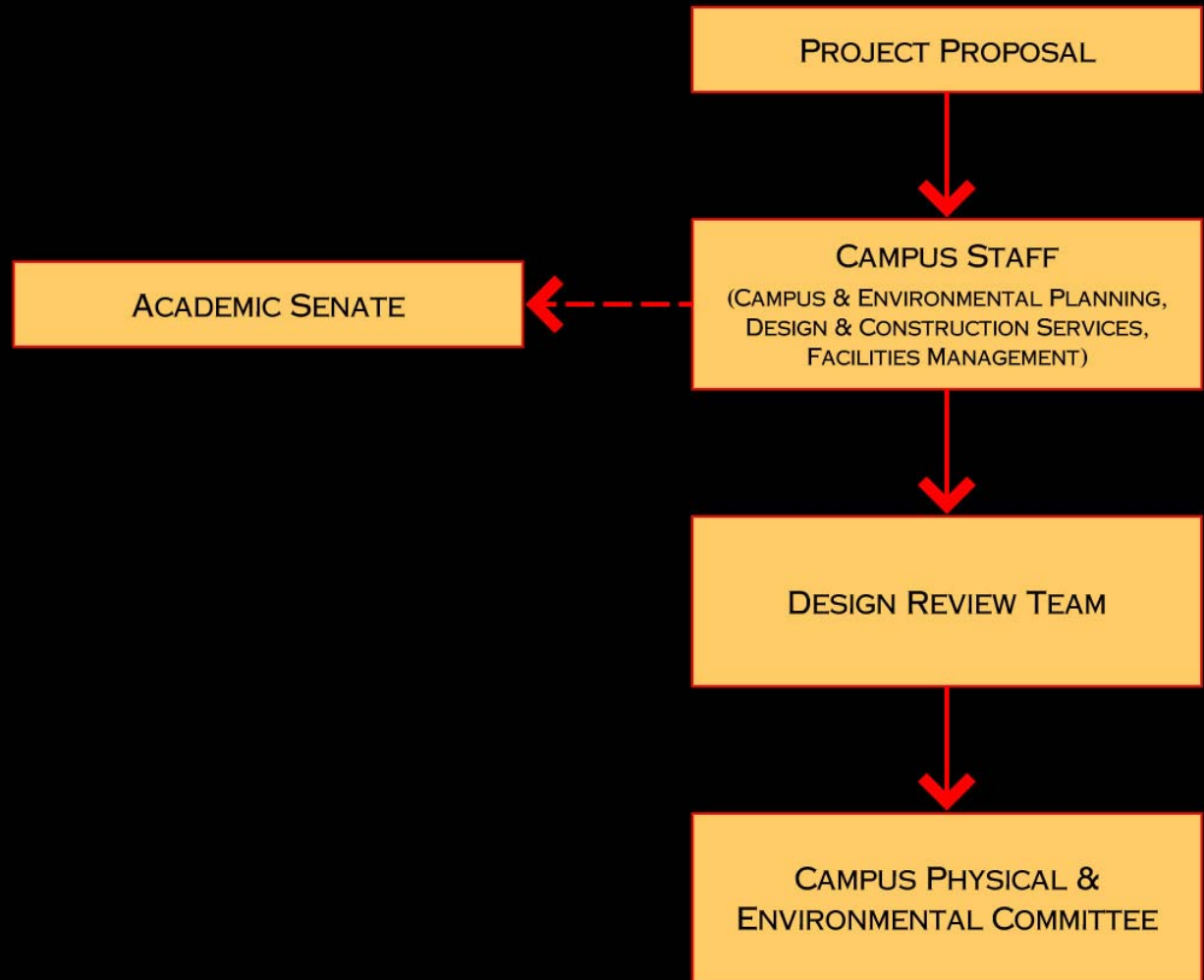

UCI REVIEW & APPROVAL PROCESS FOR DESIGN & PLANNING ISSUES

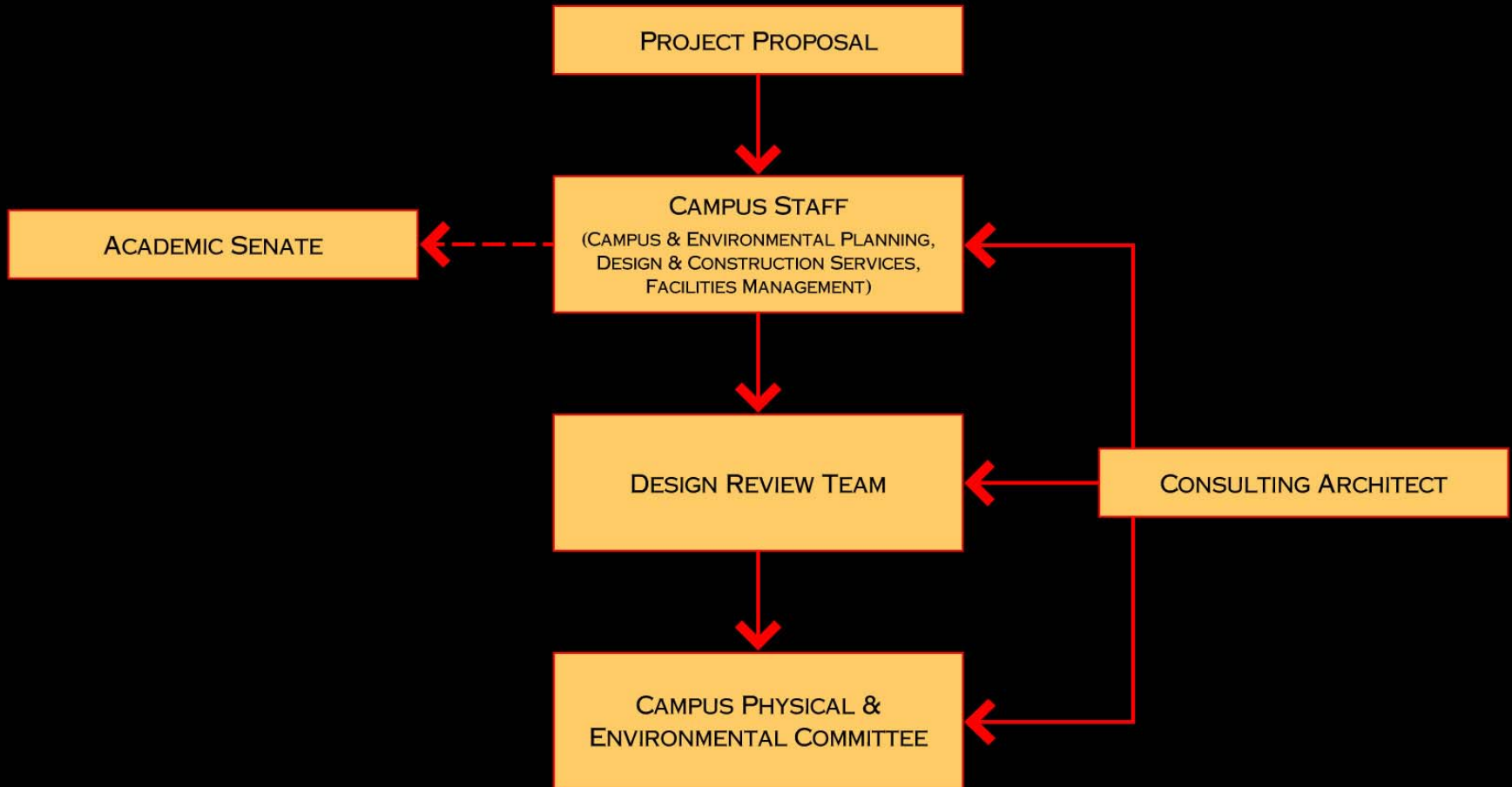

Goals and Objectives

- ❖ **Timeless architecture that conveys an experience of permanence and quality**
- ❖ **Projects that create an “identifiable place”**
- ❖ **Density management (through buildout)**
- ❖ **Reconcile scale vs. density dilemma**
- ❖ **Exemplary energy efficiency**
- ❖ **No major maintenance for twenty years**
- ❖ **On-time, on-budget**
- ❖ **Circulation and parking that reinforce campus design goals**
- ❖ **Most attractive research campus in U.S.**

UCIrvine

